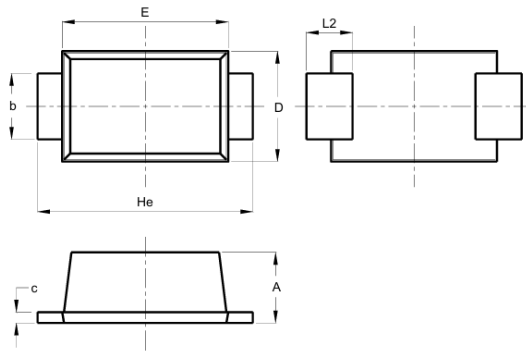

SMD Schottky Rectifier Diode

Primary characteristics		
Parameter	Value	Unit
Repetitive peak reverse voltage	20 ~ 200	V
Average rectified output current	3.0	A

Features

- Ideal for surface mount applications
- Easy pick and place
- Built-in strain relief
- Low forward voltage drop
- Molding compound meets UL 94 V-0 flammability rating, RoHS compliant, halogen free
- Terminals: tin plated leads, solderable per MIL-STD-202F at max. temp 260°C

Case dimensions							
							
SOD-123FL							
Unit mm	A	b	c	D	E	He	L2
MIN	1.00	0.80	0.12	1.75	2.60	3.55	0.50
MAX	1.20	1.10	0.20	1.95	2.90	3.80	0.85

Absolute maximum ratings and general electrical characteristics

(T_a = 25°C unless otherwise specified, single phase half wave 6Hz, resistive or inductive load, for capacitive load, derate current by 20%)

Parameter	Symbol	Value								Unit
		K32	K33	K34	K35	K36	K38	K39	K310	
Repetitive peak reverse voltage	V _{RRM}	20	30	40	50	60	80	90	100	V
RMS voltage	V _{RMS}	14	21	28	35	42	56	63	70	
DC blocking voltage	V _{DC}	20	30	40	50	60	80	90	100	
Average rectified output current	I _O	3.0								A
Peak forward surge current, 8.3 ms single half sine-wave (JEDEC method)	I _{FSM}	80								
Instantaneous forward voltage at 3.0A	V _F	0.55			0.70		0.85			V
DC reverse current	T _a =25°C	0.1				0.02				mA
	T _a =100°C	5				2				
Typical junction capacitance at 1MHz, 4Vdc	C _j	300								pF
Typical thermal resistance junction to lead	R _{θJL}	10								°C/W
Storage temperature	T _{STG}	-65 ~ 150								°C
Operating junction and storage temperature range	T _j	-65 ~ 150								

Typical characteristic curve

Typical reverse characteristics

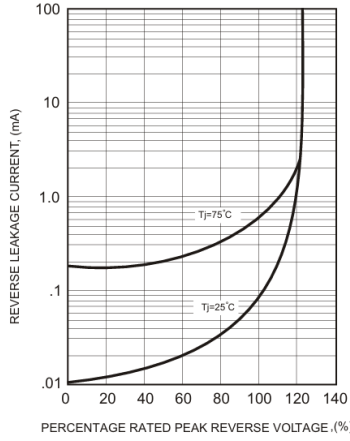

Typical forward characteristics

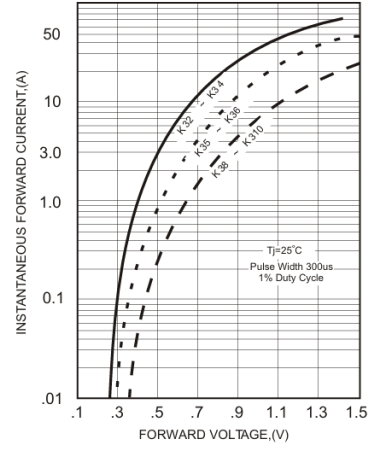

Typical forward current derating curve

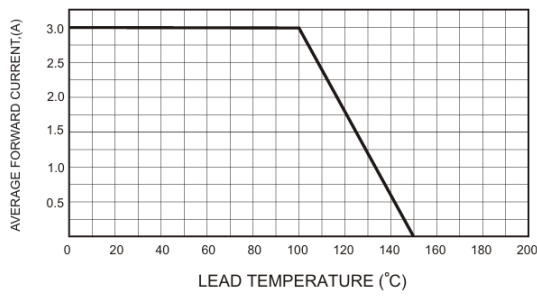

Maximum non-repetitive forward surge current

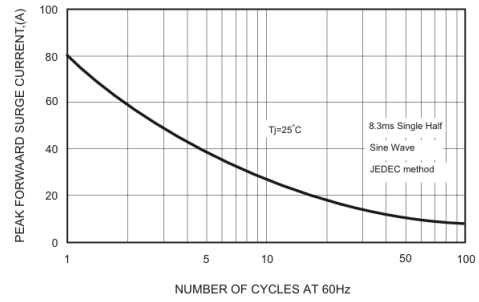

Typical junction capacitance

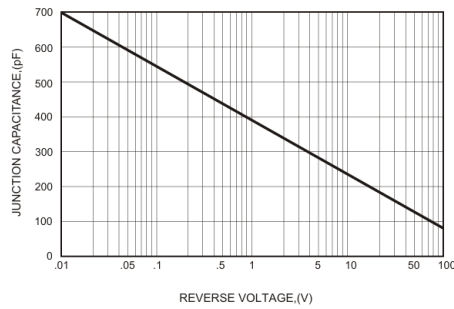

Suggested soldering pad layout

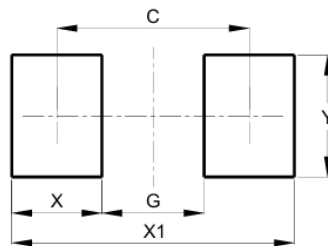

Dimension	Value mm
C	3.25
G	2.00
X	1.25
X1	4.50
Y	1.50

Ordering information		
Part Number	Package	Shipping Quantity
K32~K310	SOD-123FL	10 000 pcs / reel

Disclaimer

Akyga semi reserves the right to make changes without notice to any product specification herein, to make corrections, modifications, enhancements or other changes. Akyga semi or anyone on its behalf assumes no responsibility or liability for any errors or inaccuracies. Data sheet specifications and its information contained are intended to provide a product description only. "Typical" parameters which may be included on Akyga semi data sheets and/ or specifications can and do vary in different applications and actual performance may vary over time. Akyga semi does not assume any liability arising out of the application or use of any product or circuit. Akyga semi products are not designed, intended or authorized for use in medical, life-saving implant or other applications intended for life-sustaining or other related applications where a failure or malfunction of component or circuitry may directly or indirectly cause injury or threaten a life without expressed written approval of Akyga semi. Customers using or selling Akyga semi components for use in such applications do so at their own risk and shall agree to fully indemnify Akyga semi and its subsidiaries harmless against all claims, damages and expenditures.